

# VT3015S-12

Formerly NPS-12D10S. Use with Ventex AC Adapter\*\*

## FEATURES

- Offers a scripting effect
- UL and cUL listed to UL 2161
- Small size and lightweight
- Low-voltage input
- Use standard gas pressure



## SPECIFICATIONS

Input Voltage	11 to 14VDC
Input Current	600mA rms (normal) at full load
Output Voltage	0V-3,000V
Output Current	15mA
Operating Temp	32°F to 104°F / 0°C to 40°C
Driving Distance* (Based on Standard 12mm tube. Deduct one foot from driving footages for additional pair of electrodes.)	
Neon	3-10 ft (0.9-3.0 m)
Mercury	4-12 ft (1.2-3.6 m)

\*See Ventex Luminous Tube Footage Chart for more information.

## DIMENSIONS

Length (A)	3.20 in	8.1 cm
Width (B)	1.75 in	4.4 cm
Height (C)	1.20 in	3.0 cm
Mounting (D)	2.85 in	7.2 cm
Mounting (E)	0.20 in	0.5 cm
Weight	5.6 oz	159 g
Primary Leads	8.0 in	20.3 cm
GTO Leads	18.0 in	45.7 cm

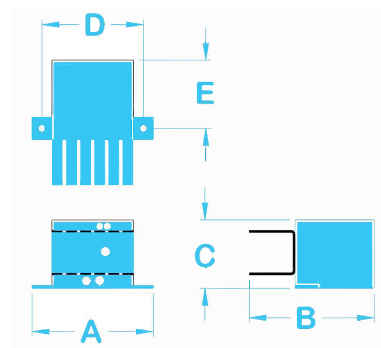

Male connector to mate with wall adapter power supply.

\*\*NOTE: Use with Ventex AC Adapter, found on Page 29 of this catalog.